

No 10 - 322/17

dt 13-11-17

To

The Tahasildar, Malkajgiri

Re: Enquiry report regarding status of land in the name of SEED, Tandapali

Ref: your letter no 3127/17, dt 6-11-17

Madam,

As per your order I visited to Tandapali village to enquiry the status of land in the name of SEED and it reveals that the Social Endowment for Environment and Development (SEED) is functioning at Tandapali over khata no 613, Plot no. 2860 and 2871 measuring an area of 10.148 and 12.404 Hectare Dargah II and Dargah I respectively since 2003-04. Now in this plots SEED's building also functioning over the land and the strength of the budget is new 70(L), and now this land is free from encumbrance

hence it is for information and take necessary action.

Enclos: trace map

Yours faithfully

Revenue Inspector
Tamasra

1. 2878 - Tandapali
 2. 2877 - Markengdu
 3. 2876 - Markengdu
 4. 2875 - Markengdu
 5. 2863 - Markengdu
 Scale - 1:4000

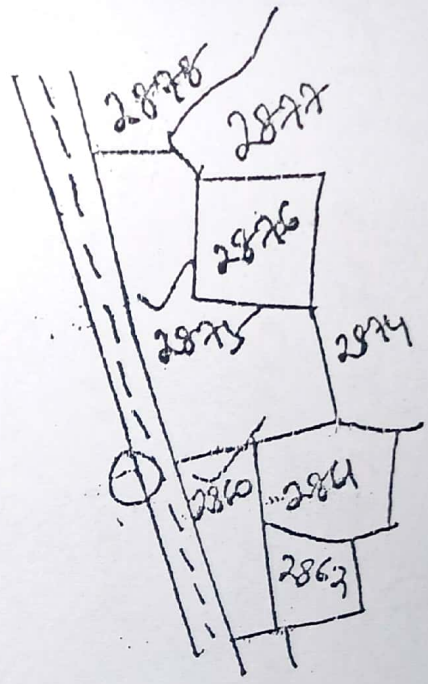

Land Schedule

| <u>K. No</u> | <u>Plot No</u> | <u>K. No</u> | <u>Band</u> | <u>Sur. %</u> |
|--------------|----------------|--------------|-----------------|-----------------|
| 643 | 2860 | Dargah-II | HL 0.148 | HL 0.148 |
| | 2875 | Dargah-I | HL 0.405 | HL 0.405 |
| | <u>52</u> | | <u>HL 0.553</u> | <u>HL 0.553</u> |

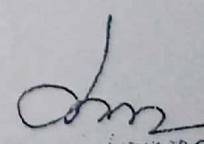
 10000-147
 10000-147